

OFFICIAL ZONING ATLAS

INDIAN RIVER COUNTY, FLORIDA

Section 26 32S-39E

Map Number: 18.12

Map Date: Dec 11, 2009



Community Development Department
1801 27th Street
Vero Beach, FL 32960
Phone: 772-226-1237

MAP LEGEND

- PLSS Section Corners
- City Limits
- TieBar Lines
- Special Corridors
- County Line
- Meander Lines
- Section Lines
- Tracts & Aliquot Parts
- Parcel Boundaries

ZONING

- | | | | | | |
|--|-------|--|--------|--|--------|
| | A-1 | | CRVP | | RM-4 |
| | A-2 | | IG | | RM-6 |
| | A-3 | | IL | | RM-8 |
| | AIR-1 | | MED | | RMH-6 |
| | CG | | OCR | | RMH-8 |
| | CH | | PD | | RS-1 |
| | CL | | PDTND | | RS-2 |
| | CN | | PRO | | RS-3 |
| | CON-1 | | R-BCID | | RS-6 |
| | CON-2 | | RM-10 | | RT-6 |
| | CON-3 | | RM-3 | | Rose-4 |

LOCATOR MAP

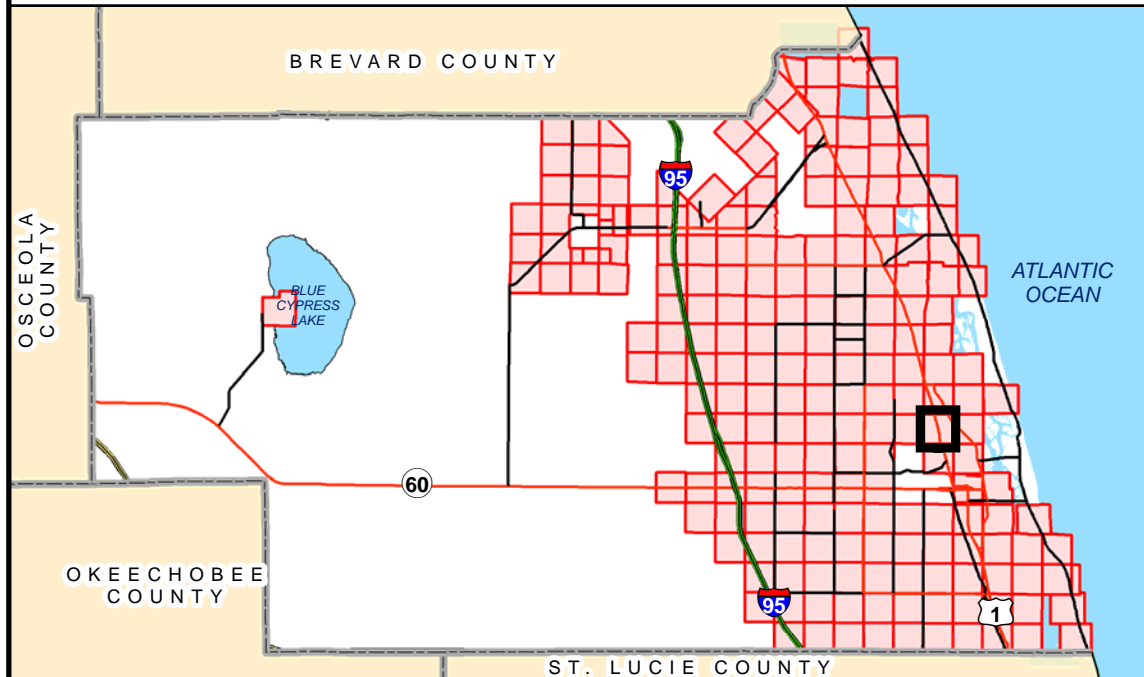

NOTE: Undeveloped riverfront wetlands are zoned Con-2, subject to survey verification. Contact county environmental planning staff for more information.

NOTE: Zoning designations adjacent to the St. Sebastian River may include Con-2 and Con-3, contingent upon site-specific environmental surveys. Such surveys require county staff approval and will set the precise boundary of Con-2 and Con-3.

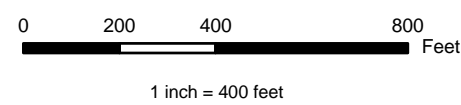

INFORMATIONAL PLAT - NOT A SURVEY

THE INFORMATION CONTAINED HEREIN IS TAKEN FROM RELIABLE SOURCES HOWEVER, ITS ACCURACY IS NOT GUARANTEED STATE PLANE COORDINATES, NAD83/90

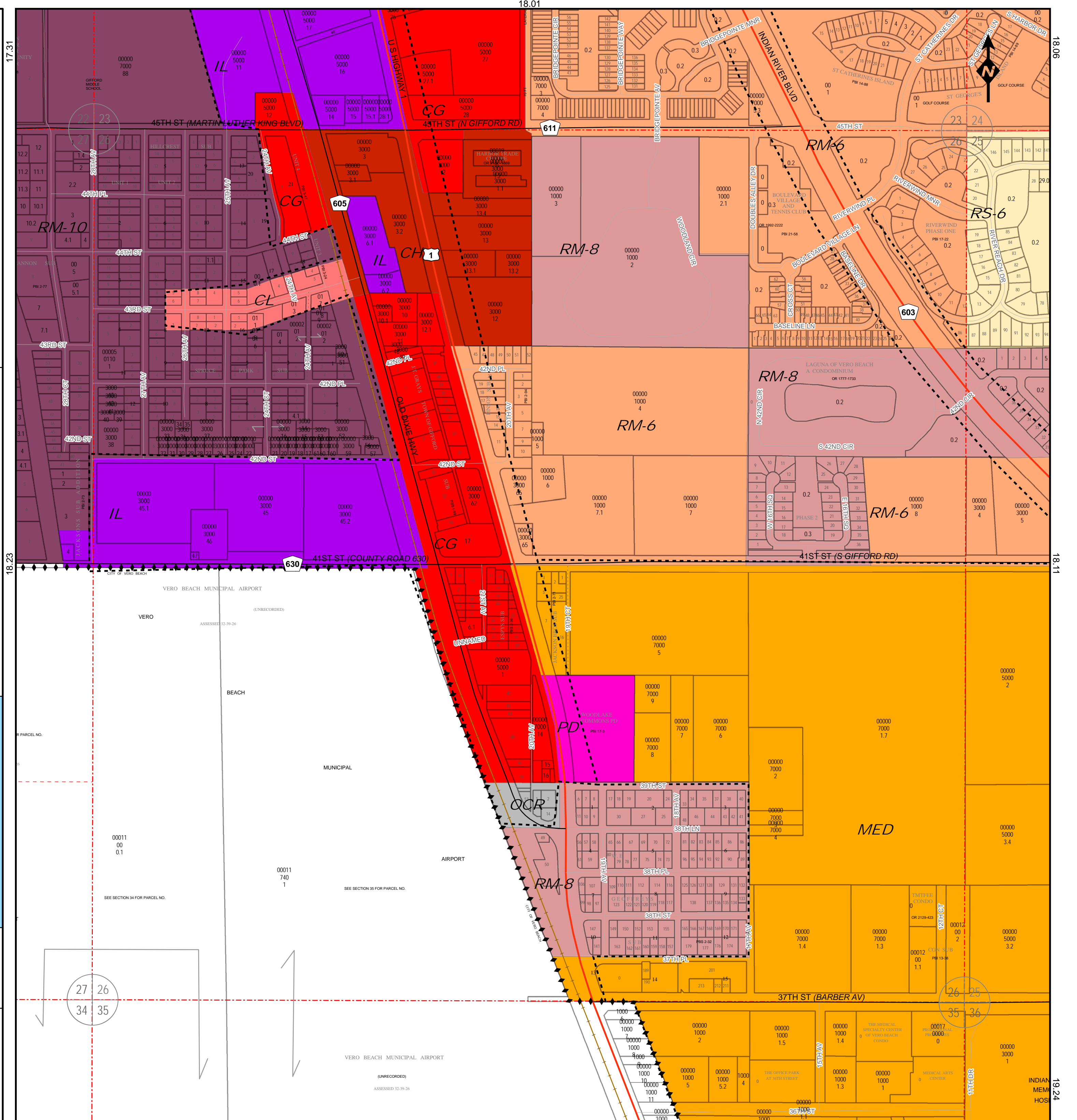

27 26
34 35

26 25
35 36